

... to support higher cutting forces

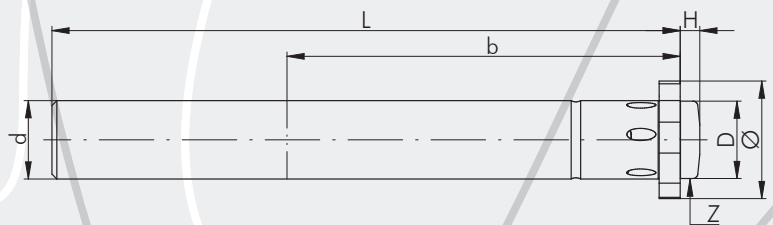

Insert holder steel, short and long version, with a central clamping screw

RXD 16 10 100SD	Ø 11.900-15.600	d _{h6} = 10	L = 100	b = 60	H = 2.5	D = 9.8	Z = C00 90 22
RXB 16 10 100SD	Ø 11.900-15.600	d _{h6} = 10	L = 100	b = 60	H = 2.5	D = 9.8	Z = C00 90 22
RXD 16 10 160SD	Ø 11.900-15.600	d _{h6} = 10	L = 160	b = 60	H = 2.5	D = 9.8	Z = C00 90 22
RXB 16 10 160SD	Ø 11.900-15.600	d _{h6} = 10	L = 160	b = 60	H = 2.5	D = 9.8	Z = C00 90 22
RXD 19 12 115SD	Ø 15.601-18.600	d _{h6} = 12	L = 115	b = 70	H = 3.0	D = 11.8	Z = C00 90 23
RXB 19 12 115SD	Ø 15.601-18.600	d _{h6} = 12	L = 115	b = 70	H = 3.0	D = 11.8	Z = C00 90 23B
RXD 19 12 185SD	Ø 15.601-18.600	d _{h6} = 12	L = 185	b = 70	H = 3.0	D = 11.8	Z = C00 90 23
RXB 19 12 185SD	Ø 15.601-18.600	d _{h6} = 12	L = 185	b = 70	H = 3.0	D = 11.8	Z = C00 90 23B
RXD 24 16 128SD	Ø 18.601-23.600	d _{h6} = 16	L = 128	b = 80	H = 4.0	D = 15.8	Z = C00 90 24
RXB 24 16 128SD	Ø 18.601-23.600	d _{h6} = 16	L = 128	b = 80	H = 4.0	D = 15.8	Z = C00 90 24B
RXD 24 16 208SD	Ø 18.601-23.600	d _{h6} = 16	L = 208	b = 80	H = 4.0	D = 15.8	Z = C00 90 24
RXB 24 16 208SD	Ø 18.601-23.600	d _{h6} = 16	L = 208	b = 80	H = 4.0	D = 15.8	Z = C00 90 24B
RXD 29 20 145SD	Ø 23.601-28.600	d _{h6} = 20	L = 145	b = 95	H = 4.0	D = 15.8	Z = C00 90 24
RXB 29 20 145SD	Ø 23.601-28.600	d _{h6} = 20	L = 145	b = 95	H = 4.0	D = 15.8	Z = C00 90 24B
RXD 29 20 240SD	Ø 23.601-28.600	d _{h6} = 20	L = 240	b = 95	H = 4.0	D = 15.8	Z = C00 90 24
RXB 29 20 240SD	Ø 23.601-28.600	d _{h6} = 20	L = 240	b = 95	H = 4.0	D = 15.8	Z = C00 90 24B
RXD 36 25 170SD	Ø 28.601-35.600	d _{h6} = 25	L = 170	b = 110	H = 4.0	D = 24.5	Z = C00 90 25
RXB 36 25 170SD	Ø 28.601-35.600	d _{h6} = 25	L = 170	b = 110	H = 4.0	D = 24.5	Z = C00 90 25B
RXD 36 25 274SD	Ø 28.601-35.600	d _{h6} = 25	L = 274	b = 110	H = 4.0	D = 24.5	Z = C00 90 25
RXB 36 25 274SD	Ø 28.601-35.600	d _{h6} = 25	L = 274	b = 110	H = 4.0	D = 24.5	Z = C00 90 25B

Insert holder carbide, long version, with a central clamping screw

RXD16 10 160HMSD	Ø 11.900-15.600	d _{h6} = 10	L = 160	b = 60	H = 2.5	D = 9.8	Z = C00 90 22
RXB16 10 160HMSD	Ø 11.900-15.600	d _{h6} = 10	L = 160	b = 60	H = 2.5	D = 9.8	Z = C00 90 22
RXD19 12 185HMSD	Ø 15.601-18.600	d _{h6} = 12	L = 185	b = 70	H = 3.0	D = 11.8	Z = C00 90 23
RXB19 12 185HMSD	Ø 15.601-18.600	d _{h6} = 12	L = 185	b = 70	H = 3.0	D = 11.8	Z = C00 90 23B
RXD24 16 208HMSD	Ø 18.601-23.600	d _{h6} = 16	L = 208	b = 80	H = 4.0	D = 15.8	Z = C00 90 24
RXB24 16 208HMSD	Ø 18.601-23.600	d _{h6} = 16	L = 208	b = 80	H = 4.0	D = 15.8	Z = C00 90 24B
RXD29 20 240HMSD	Ø 23.601-28.600	d _{h6} = 20	L = 240	b = 95	H = 4.0	D = 15.8	Z = C00 90 24
RXB29 20 240HMSD	Ø 23.601-28.600	d _{h6} = 20	L = 240	b = 95	H = 4.0	D = 15.8	Z = C00 90 24B
RXD36 25 274HMSD	Ø 28.601-35.600	d _{h6} = 25	L = 274	b = 110	H = 4.0	D = 24.5	Z = C00 90 25
RXB36 25 274HMSD	Ø 28.601-35.600	d _{h6} = 25	L = 274	b = 110	H = 4.0	D = 24.5	Z = C00 90 25B

